

CERTIFICATE OF LOCATION OF GOVERNMENT CORNER

North Quarter Corner of Section **23** , Township **107** , Range **41** 5th P.M.

STATE OF MINNESOTA, County of Murray.

Statement: Sept. 6, 1989 - Found pieces of wooden stake next to Corner fence post.
Placed a Minnesota Department of Transportation
Aluminum Capped Square Iron Monument.



SKETCH OF REFERENCE TIES

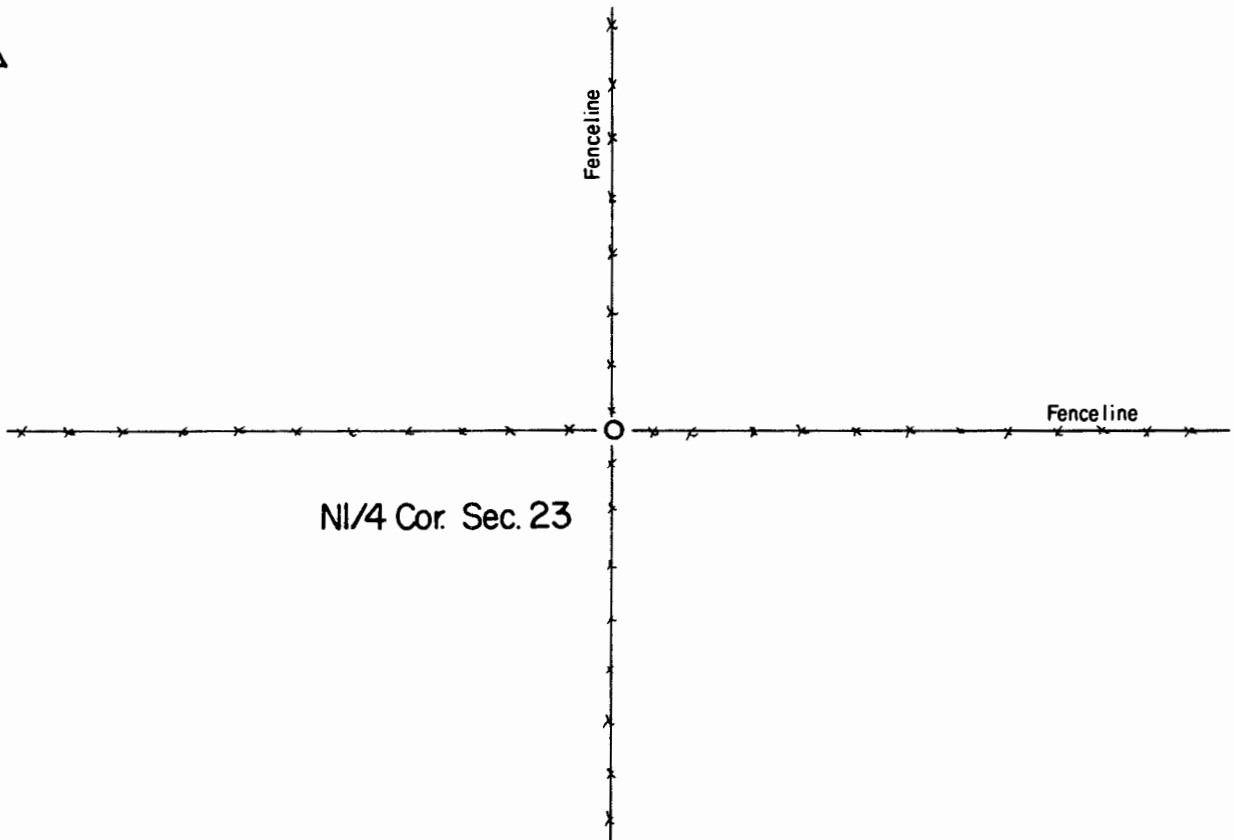

Statement of evidence relative to this corner location is on the back of page.

I hereby certify that this document and the data contained herein was prepared by me or under my direct supervision and that I am a duly Registered Land Surveyor under the laws of the State of Minnesota.

 Nov 4, 1989
Duane A. Bonnema Date

Minnesota Registration No. 14895

OFFICE OF THE COUNTY RECORDER
COUNTY OF MURRAY **NOV 15 1989**

I hereby certify that this document was filed in the County Recorder's office at ___M. on the ___ day of _____ A.D., 19__

County Recorder 

By _____, Deputy
DOCUMENT NO. _____

North Quarter Cor. Sec. 23 T107-R41W

Statement:

August 1861

Original Government Land Office Surveyor L. G. M. Fletcher records in his field notes, "built mound with trench pits, charred stake, per instructions."

Sept. 6, 1989

Duane A. Bonnema, LS Reg. No. 14895, dug around the Corner post to a depth of 3 1/2 feet. Remnant pieces of wood, which appeared to be typical of the original oak stake, were found along with several small stones which extended to a depth of 3 1/2 feet. The bottom of the hole was probed, however no additional evidence was found. The fence extends in the 4 cardinal directions and has been there for a long time. An aluminum capped Minnesota Department of Transportation Square Iron was placed at this location. The traces of the wooden post and the stones, found to a depth of 3 1/2 feet, seem to be the best available evidence and is in harmony with the long standing property line fences.